













TREVI® PRO AquaLine Duschboard mit Linienentwässerung

Werkzeuge:	Montagezubehör:
 Zollstock	 Innenecken
 Tacker	 Schnellkleber C2 FTE
 Bleistift	 Randdämmstreifen
 Cuttermesser	 Schnellestrich
 Wasserwaage	 Stufenmanschette
 Zahnkelle 8 mm	
 Wasserbehälter	

einseitiges
Gefälle

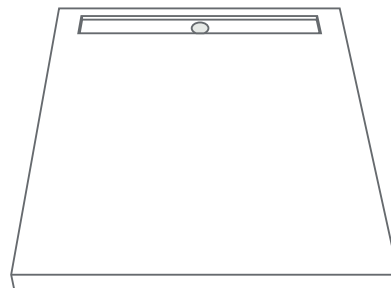

vierseitiges
Gefälle

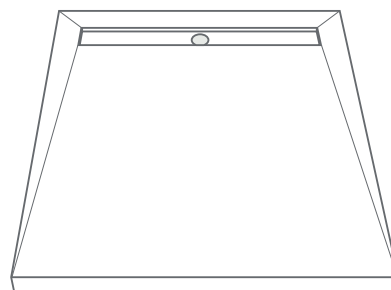

Waagerechter Ablauf

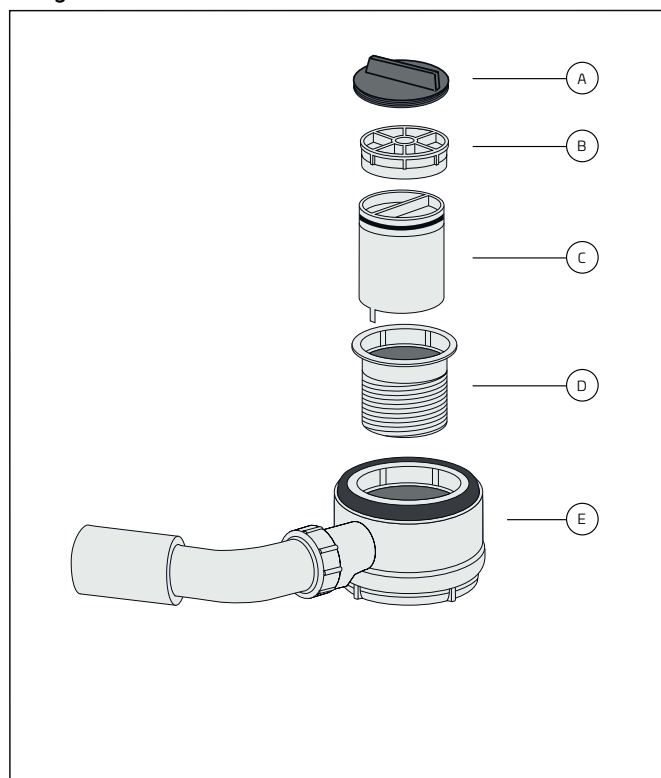

Senkrechter Ablauf

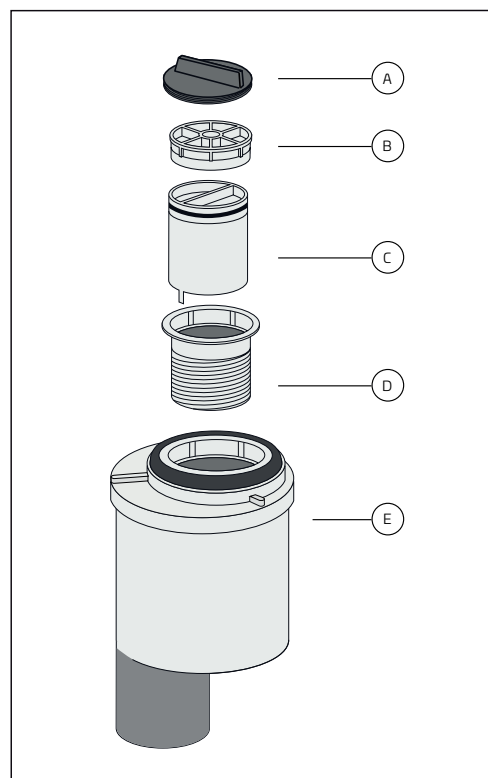

(A) Bauschutz- und Montageschlüssel
(B) Edelstahlrost
(C) Haarsieb

(D) Geruchsverschluss
(E) Ablaufgarnitur

1 Randdämmstreifen

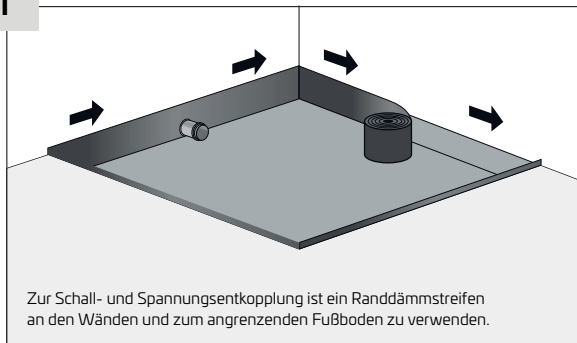

2

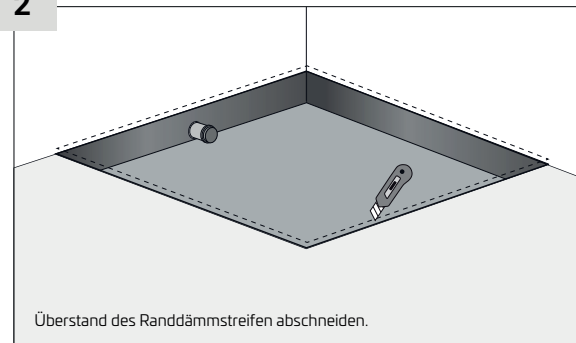

3 Abflussposition

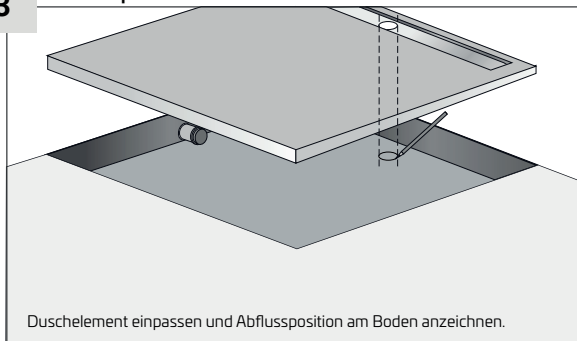

EINBAU WAAGERECHTER ABLAUF

1 Siphon positionieren

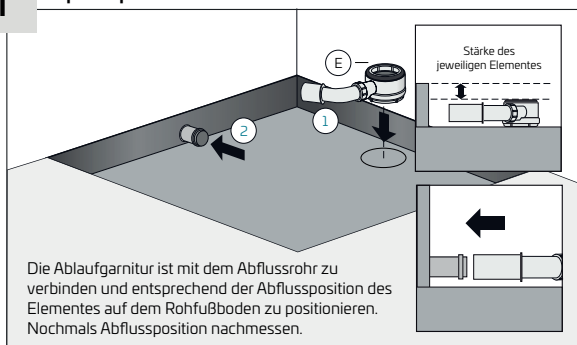

2 Dichtigkeit

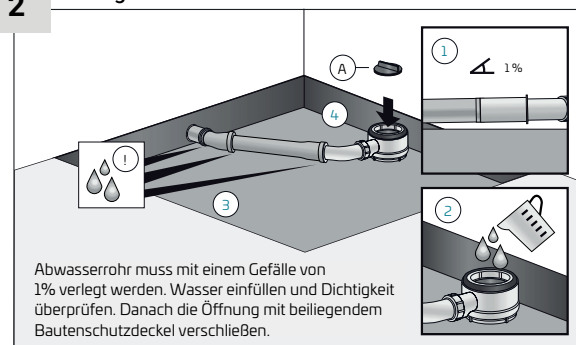

EINBAU SENKRECHTER ABLAUF

1 Siphon positionieren

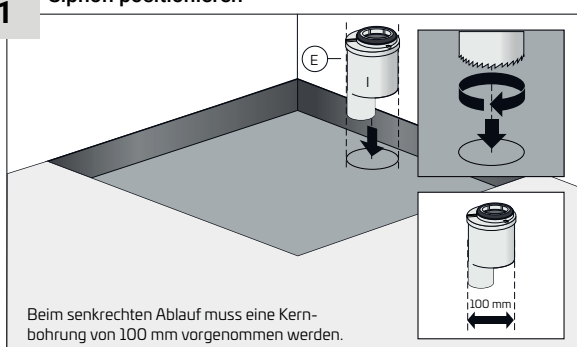

2 Dichtigkeit

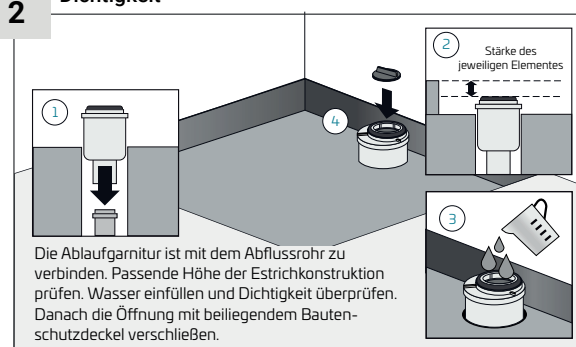

1

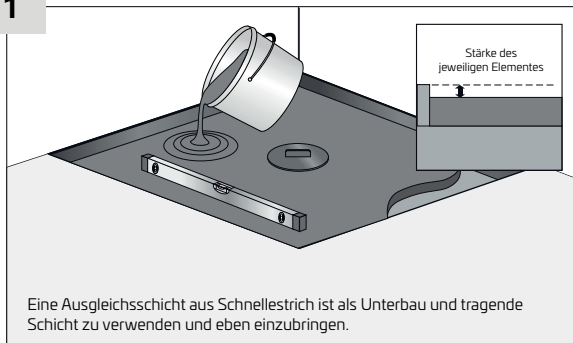

1.1

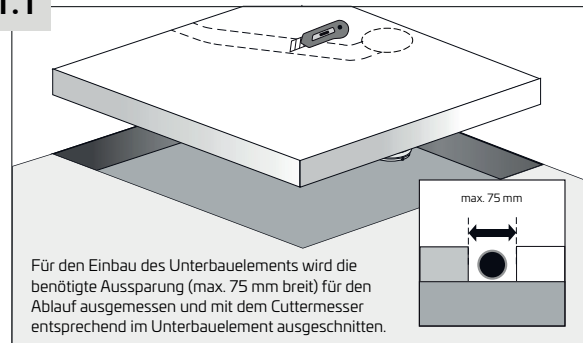

5

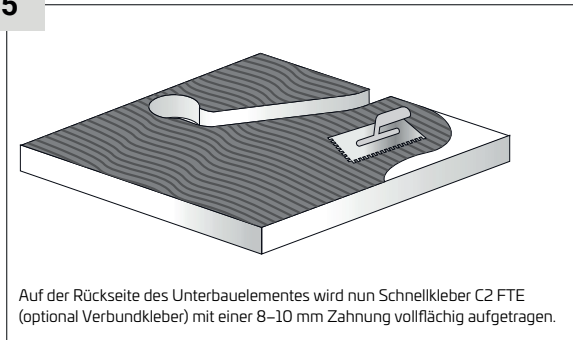

3

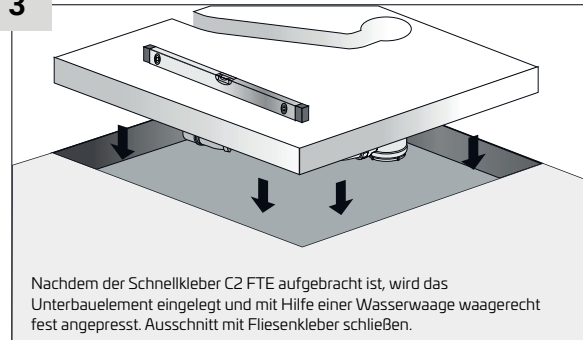

EINBAU DUSCHBOARD

1

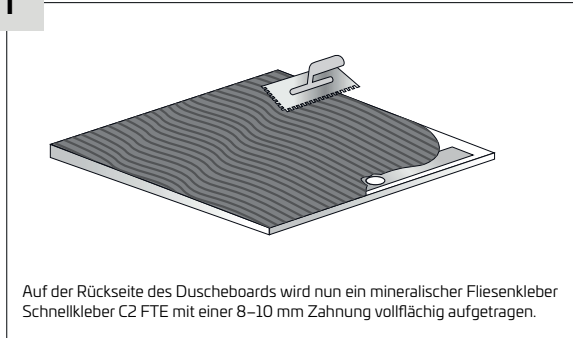

2

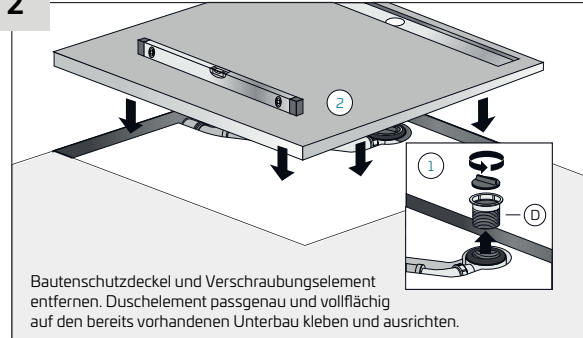

3

Distanzplättchen

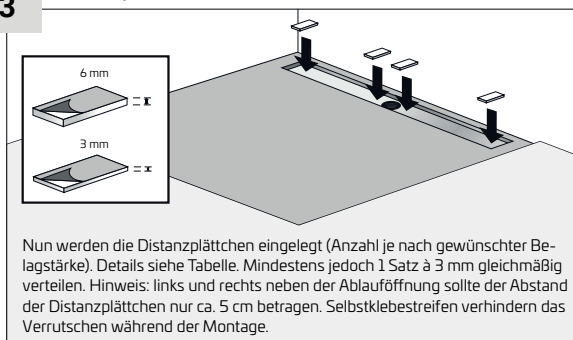

4

Duschrinne

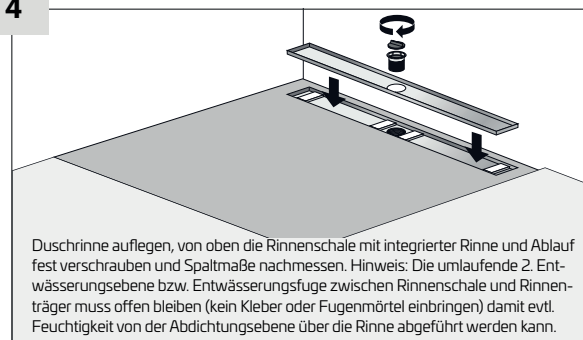

1

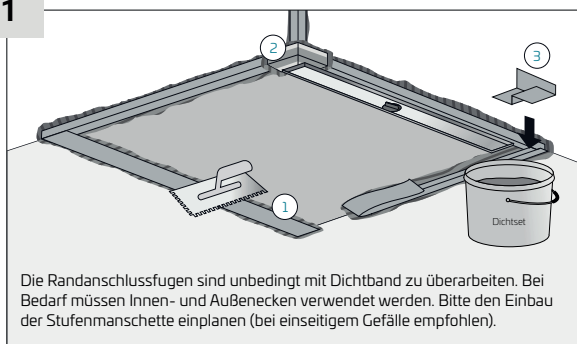

1.1 Silikonfuge

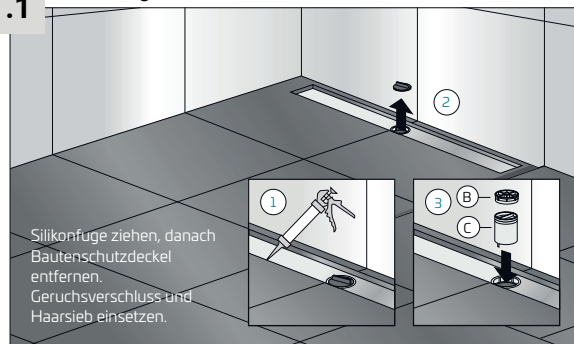

2

Edelstahlrost

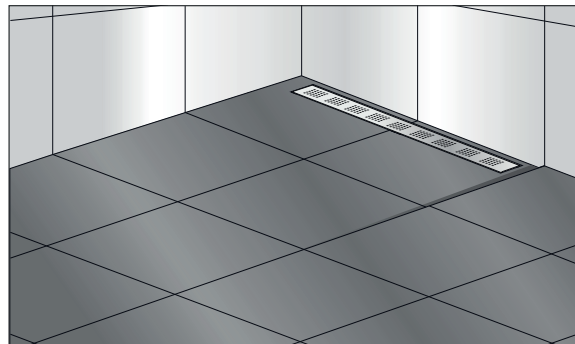
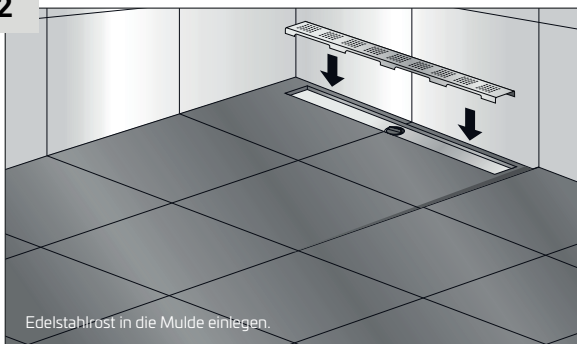

Distanzplättchen

für Belaghöhe

3 mm	6 mm
6 mm	9 mm
3 mm + 6 mm	12 mm
6 mm + 6 mm	15 mm
6 mm + 6 mm + 3 mm	18 mm
6 mm + 6 mm + 3 mm + 3 mm	21 mm

Aufteilung der Distanzplättchen in den jeweiligen Rinnenlängen

300	□ ○ □
500	□ □ ○ □ □
600	□ □ □ ○ □ □
700	□ □ □ □ ○ □ □
800	□ □ □ □ □ ○ □ □ □
900	□ □ □ □ □ □ ○ □ □ □ □
1000	□ □ □ □ □ □ □ ○ □ □ □ □ □
1100	□ □ □ □ □ □ □ □ ○ □ □ □ □ □ □
1200	□ □ □ □ □ □ □ □ □ ○ □ □ □ □ □ □ □